



PARK PRESS

Onsite Office: 25 Christamon West, 714-730-1560
Onsite Office Hours: Monday-Friday 9:00 a.m. - 5:00 p.m.

www.parkpaseoirvine.com
parkpaseohoa@gmail.com

September 2020

Annual Meeting & Election

The Park Paseo Annual Meeting & Election is scheduled to be held on **Tuesday, November 10, 2020**. Request for Candidate forms have been sent out to all homeowners. If you are considering running for a position on the Board of Directors, please consider the following: Primary Board responsibilities include making decisions for the Association that preserve and protect the value of our homes; reviewing and selecting vendor services; helping to resolve homeowner issues; and monitoring the Association costs and budgets. If you are interested in serving on the Board or if you would like further information regarding Board Member responsibilities, please contact our PCM Community Manager, Lynn Wyatt. Consider volunteering your time and talents for the benefit of our community! In addition, Ballots will be sent to all homeowners to be completed in October. Once received, take a few moments to complete the Ballot and return it in the envelope provided. The Board of Directors strongly urges ALL homeowners to vote! However, if you are not comfortable voting for a particular candidate, simply mark the "For Quorum Purposes Only" box, sign and return the ballot so it can be counted toward quorum. In the past, the Association has not received enough ballots to achieve quorum. When this occurs the Association is required to hold a reconvened Annual Meeting. Please note that this costs the Association money and additional work each year.

Please help the Association achieve a successful Annual Meeting and reduce Association costs by sending in your ballot by the date requested.
THANK YOU!

Clubhouse Pool Deck Project

As reported last month, the Prosa Pool Project is completed and it turned out beautifully. Both community pools are open through September. Please enjoy our pool facilities while maintaining physical distancing, etc. Please refer to the Pool Reopening Rules. The Clubhouse Pool & Spa will be closing October 1st and the Deck Remodel Project will begin. The Clubhouse Pool Deck Project will take approximately five months to complete. The entire pool area will be closed and off limits to all residents. The tennis courts will remain open, for now. The Board is trying to determine a way to keep the tennis courts open during the project. We appreciate your cooperation during this time. Please contact the onsite office if you have questions or concerns.

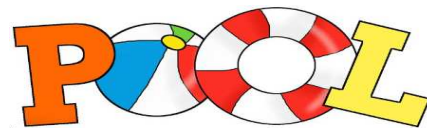

Our pools are open through
September 30, 2020... ENJOY!

POOL HOURS

MAIN POOL

Sunday-Thursday: 7:00 a.m. to 10:00 p.m.
Friday & Saturday: 7:00 a.m. to 11:00 p.m.

PROSA POOL

Sunday-Thursday: 7:00 a.m. to 9:00 p.m.
Friday & Saturday: 7:00 a.m. to 10:00 p.m.

**NO LIFEGUARD
ON DUTY**

No pets allowed in the pool area. Only official Service
Dogs or Guide Dogs are allowed in the pool area.

Zero Lot Lines

The Association often receives questions regarding the zero lot lines/easements in the community. Oftentimes homeowners say “they didn’t know about the easement”. Please note that this information was given to all homeowners in our CC&Rs, “Section 3, Sideyard Easements” upon purchasing your home in Park Paseo. The sketch below (from our CC&Rs) indicates the location of the 5' side yard easement and the designation of dominant and servient tenements and property line. All other measurements, figures, and references are purely for illustrative purposes and do not necessarily represent actual measurements and actual data pertaining to the real property. Please keep in mind that it is each homeowner’s responsibility to be familiar with the Association’s CC&Rs and Rules & Regulations. If you have any questions please email parkpaseohoa@gmail.com.

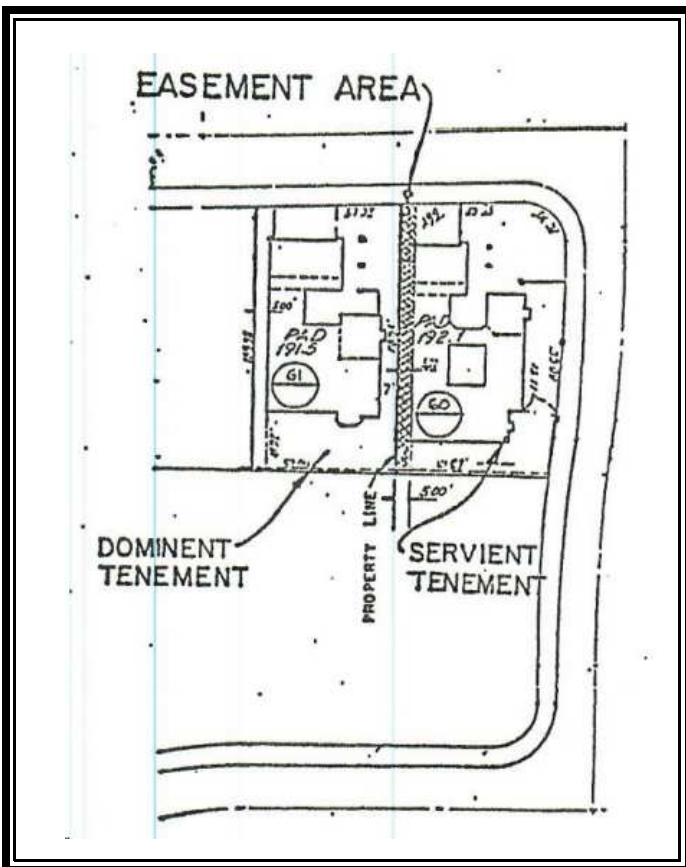

Our Dog Waste Stations

The dog waste bag stations in our community are for the use of all Park Paseo pet owners. However, it has been reported that some dog owners are “stocking up” on the waste bags, not leaving enough bags for other residents. Ultimately, dog owners are responsible to provide their own dog waste bags. The waste stations have been installed in our community as a courtesy and are for your use if you have forgotten to bring a waste bag for your dog. When using the Association’s dog waste bags, please only use as many as are needed for your walk to ensure there are plenty of bags on hand for all Park Paseo pet owners. Thank you for being a responsible pet owner and courteous neighbor.

Trash Pickup Day Is Monday

A reminder to all homeowners that trash cans are not to be left out more than 24 hours total. Please put your cans out Sunday night at the earliest, and put them away, out of sight, once the pickup has occurred, or Monday evening at the latest. Please try to avoid rolling trash cans out in the morning hours as this may awaken your surrounding neighbors. If you are going to be out of town on trash pickup day, please ask a neighbor to help you out. In addition, be sure that trash receptacles are closed securely to prevent critters from getting in, and trash from falling out and being blown throughout the community. Thank you for doing your part to keep our community looking its best.

Please Trim Your Bushes & Trees

A friendly reminder that your bushes and trees are your responsibility to maintain, water and trim on a regular basis. Please keep in mind that trees must be trimmed high enough for the trash trucks as well as the street sweeper to drive under them. If the trash truck or street sweeper cannot drive under your tree, you may incur fees to have them come back. In addition, please trim all trees and bushes that hang over the sidewalk to ensure our neighbors can easily walk by.



**Please bring box tops to the onsite office
to support Santiago Hills Elementary
School program funding! KEEP 'EM COMING!**

*Thank you for taking the time to ensure
that your trees and bushes are always
well maintained and trimmed properly.*

Want To Know What's Up?

Each month the upcoming Board meeting agenda is posted in the Clubhouse & Prosa pool bulletin boards four days prior to the meeting for General Session and two days prior for Executive Session in accordance with Civil Code.

Got Questions Regarding Your Assessment Account?



If you have a question concerning your homeowner assessment account, contact PCM's Customer Care Center at 800-369-7260 or pro.info@associa.us. A PCM representative will be happy to assist you with your inquiry.



**Board meetings are held on the
2nd Monday of every month:**

**Next Board Meeting
Monday, September 14, 2020
7:00 p.m. Clubhouse Patio**

**Architectural meetings are held on
the last Wednesday of every month:**

**Next Architectural Committee Meeting
Wednesday, September 30, 2020
7:00 p.m. Clubhouse Patio**

IMPORTANT: Social distancing and masks are required to attend any Park Paseo meeting.

4th OF JULY FUN!

Thank you again to those families who helped make our community a little more festive for the 4th of July. You're the best!



SEPTEMBER STREET SWEEPING
West of Yale: Friday, September 4th & 18th
East of Yale: Friday, September 11th & 25th
Please move vehicles off the streets on street sweeping days.



1 Civic Center Plaza, Irvine, CA 92606
www.cityofirvine.org

Public Works: 949-724-7516

Administrative Services: 949-724-6255

Animal Services: 949-724-7091

Parking Enforcement: 949-724-7000

Street Sweeping: 949-724-7600

Short-Term Rentals: 949-269-3600

Irvine Police Department / Noise Nuisance
Non-emergency: 949-724-7000

Code Enforcement
codeenforcement@cityofirvine.org



ON-CALL BOARD MEMBER

Please contact Lynn Wyatt at
the onsite office at 714-730-1560
prior to contacting a Board Member.

September On-Call Board Member:
Jim McMillen - 714-730-5047

*Stay Safe
and
Healthy*

from the Park Paseo HOA

Board of Directors

Gus Aarnaes, President

Yumi Renshus, 1st Vice President

Jim McMillen, 2nd Vice President

Jerry Cheng, Secretary

Mina Brooks, Treasurer



27051 Towne Centre Drive, Suite 200

Foothill Ranch, CA 92610

949-768-7261 OR 800-369-7260

Customer Care Center & After-Hours Emergencies

ONSITE COMMUNITY MANAGER: Lynn Wyatt

Onsite Office: 714-730-1560

parkpaseohoa@gmail.com



Enjoy the final days of summer....

This publication is a private newsletter, the contents of which are intended solely for the use and benefit of the Members of the Park Paseo Homeowners Association. The Association, its directors and agents make no representation as to the accuracy, completeness, suitability, or validity of the information contained herein, including but not limited to any advertising or information from third-party vendors and pertaining to such services as lawn care, real estate, babysitting, house cleaning, home repair, or similar. The Association, its directors and agents shall not be liable for any errors, misrepresentations, omissions, delays or injuries arising from the publication or use of such information. The views and opinions expressed herein are those of the authors and do not necessarily reflect the official policies or practices of the Association. The readers of this publication may rely on any information, opinions or representations presented herein at their own risk.